

This drawing is the property of Leeds City Council. It must only be used for the purpose for which it was originally supplied. It must not be copied, published or transmitted by any means to any third party, without the express permission of the originator. Modification or manipulation of all or part of this drawing is strictly forbidden, unless specifically requested or approved by the originator.

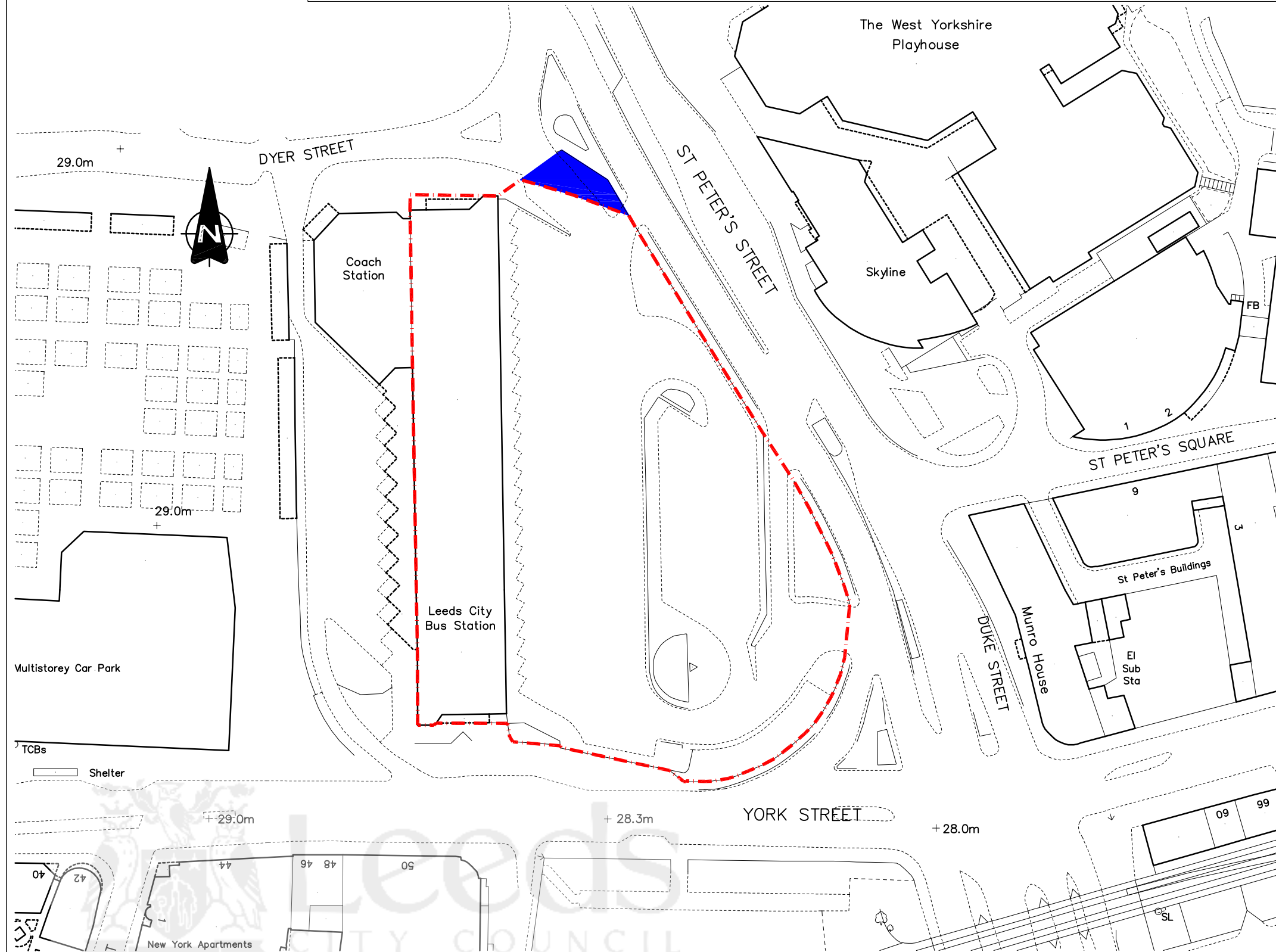

KEY

--- PROPOSED WYCA BOUNDARY

 WYCA LAND TO BE DEDICATED AS PUBLIC HIGHWAY

Notes:

1. This drawing is for information only.

© Crown Copyright and database right 2015 Ordnance Survey LA100019567

ST PETER'S STREET – CROSSING & BUS STATION EGRESS
CITY AND HUNSLET WARD
MISCELLANEOUS DRAWING
REVISED LAND REGISTRY BOUNDARIES

	INITIALS	DATE	SCALE
DRAWN BY	DOD	11/16	1:1000
AutoCAD BY	DOD	11/16	
CHECKED BY			ORIGINAL SHEET SIZE A3

Leeds
CITY COUNCIL
HIGHWAYS AND TRANSPORTATION

FIRST APPROVED	DOD		
AMENDMENTS	DRAWN	CHECK	DATE
TM/10/2496/MIS/01 INFORMATION			
STATUS:		DRAFT	
DATE:		November 2016	